

## SERIES 5000 VERTICAL LIFT COUNTERWEIGHT DOOR

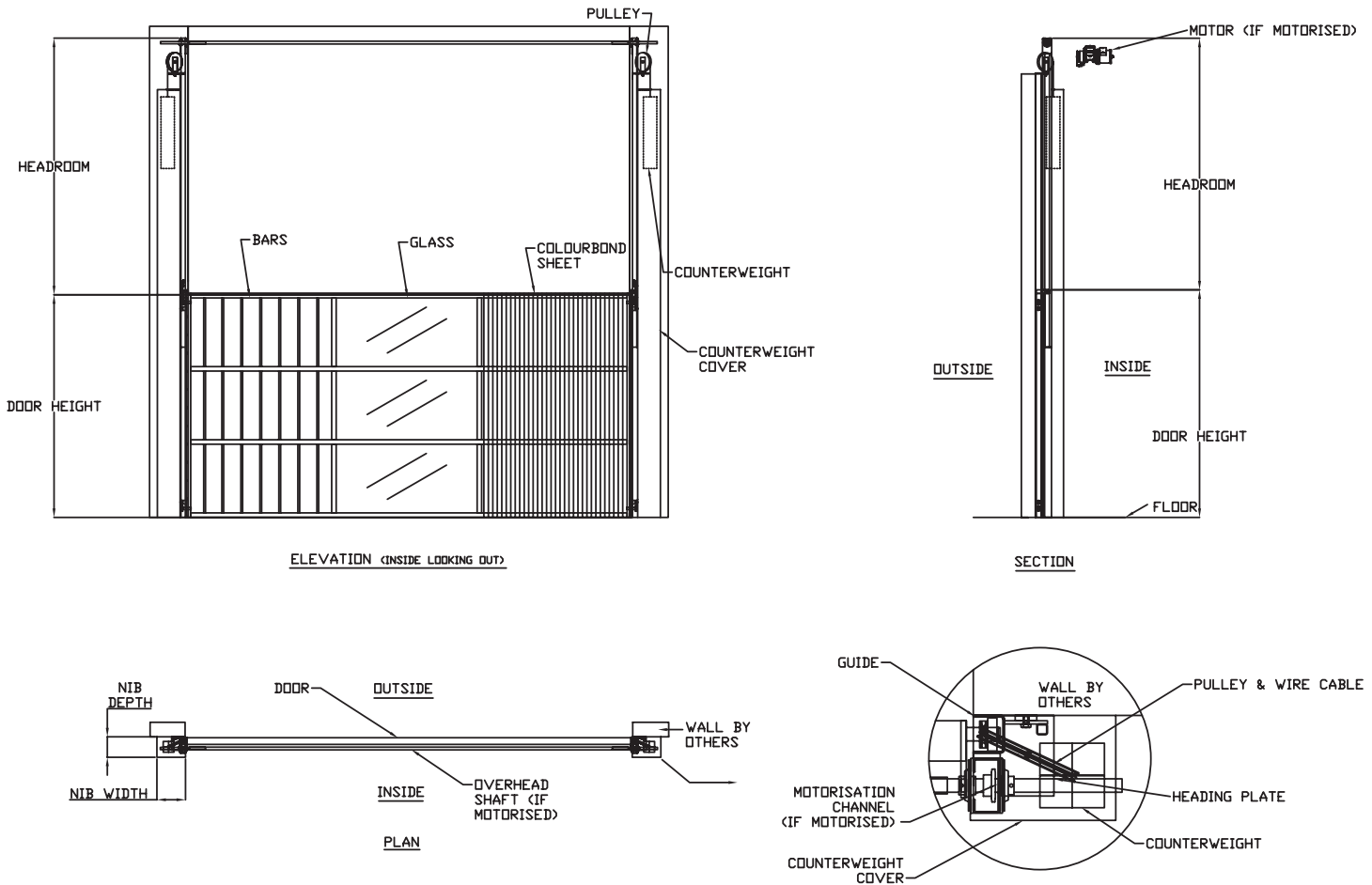

**HEADROOM AND SIDEROOM CLEARANCES:**

Door Width	Up to 3000mm	3000mm - 7000mm	7000mm - 10000mm
Nib Width	160mm - 200mm	200mm - 250mm	250mm - 400mm
Nib Depth	190mm - 220mm	220mm - 250mm	250mm - 400mm
Headroom - Manual Door	Door height + 200mm	Door height + 300mm	Door height + 375mm
Headroom - Motorised Door	Door height + 400mm	Door height + 400mm	Door height + 400mm

**NOTES:**

- Counterweight doors must be installed to structural surfaces. Suitable materials include concrete, core – filled masonry, RHS steel or PFC channels. Unsuitable materials are metal stud walls, office partition walls or hollow masonry. Jamb must be plumb and true.
- All counterweight door tracks are fitted behind the walls – not between or in front of the walls.
- Mirage counterweight doors are suitable for high cycle applications.
- The maximum recommended opening size for a Series 5000 door is 10000mm wide x 8000mm high. Consult the manufacturer should opening size requirements exceed this size.

Mirage Doors has a continuous program of product development and reserves the right to change specifications at any time without notice.